

INALWAYS INLET 0721-2 SERIES

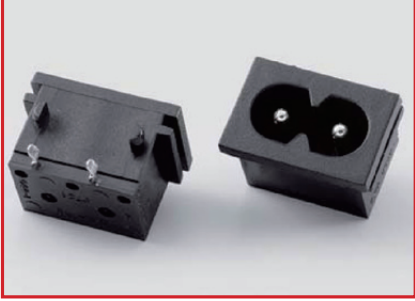

IEC Connector EN60320 C8

Ratings

Europe / UL & CSA:
2.5A 250Vac
UL:
7A 125Vac

Approvals

UL
CSA
ENEC (16)
CCC

Mounting

P: Snap-in

Terminal

P1: PCB Pin

Unit: mm

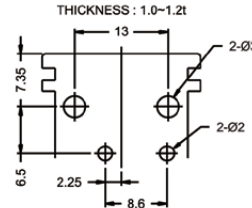
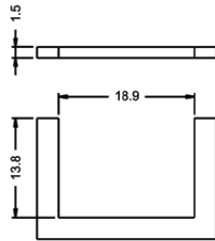
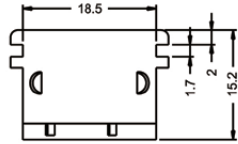
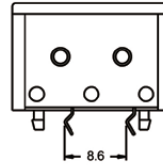
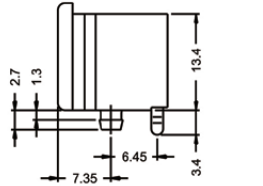
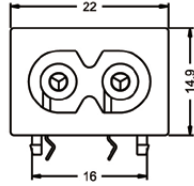

PANEL CUT-OUT

PCB LAYOUT

INALWAYS INLET 0724 SERIES

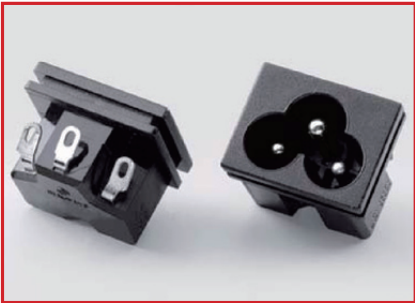

IEC Connector EN60320 C6

Ratings

Europe / UL & CSA:
2.5A 250Vac
UL & CSA:
7A 250Vac CSA
7A 125Vac UL

Approvals

UL
CSA
ENEC (16)
CCC
KC

Mounting/Terminal

PP: Snap-In / PCB Pin
PS: Snap-In / Solder Tab

Dimension Option

7: View A
7M: View A + Metal Clip
9-C3: View B

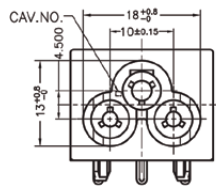

VIEW "A"

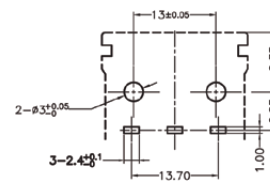
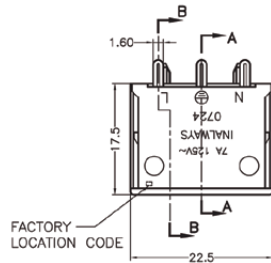

PCB LAYOUT
THICKNESS: 0.8~1.6t

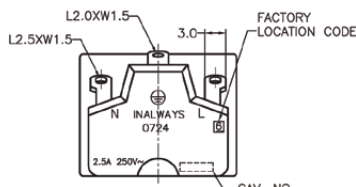

VIEW "B"

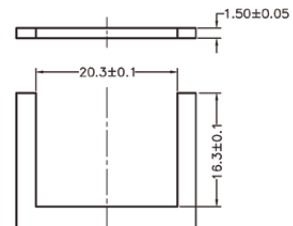
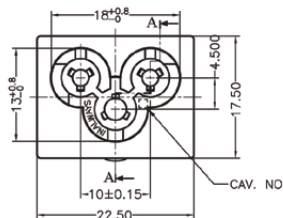

PCB LAYOUT

Unit: mm